

An Equal Opportunity Employer

Phone: 296-2428



STATE OF MINNESOTA
MUNICIPAL BOARD

Suite 165 Metro Square
7th & Robert Streets
St. Paul, Minnesota 55101

Ms. Carole Grimm
City Clerk
City Hall
Rochester, MN 55901

Re: Docket Number A-3540

Ordinance Number 2060

City of Rochester

Dear City Clerk:

The Minnesota Municipal Board has now processed and approved the above ordinance and filing fee in accordance with Minnesota Statutes, Chapter 414, and the Rules of Procedure.

According to law, this annexation ordinance must be filed with the Township Clerk, County Auditor, Secretary of State and the Municipal Board. (Since the ordinance has already been filed with the Municipal Board, no additional copies are required.)

The annexation is final upon the date the ordinance is approved by the Board, which is the date of this letter.

Sincerely,

MUNICIPAL BOARD

A handwritten signature in cursive script, reading "Patricia D. Lundy".

Patricia D. Lundy
Assistant Executive Director

PDL:kj

cc: Secretary of State
County Auditor
Township
Attorney
Municipality

(REVISED 7/78)

STATE OF MINNESOTA
DEPARTMENT OF STATE
FILED
OCT - 1 1979
Jesse Anderson Howe
Secretary of State

3242

ORDINANCE NO. 2060

AN ORDINANCE ANNEXING TO THE CITY OF ROCHESTER, MINNESOTA, CERTAIN UNPLATTED LAND NOT EXCEEDING 200 ACRES IN AREA SITUATED IN SECTION 3, TOWNSHIP 106 NORTH, RANGE 14 WEST, OLMSTED COUNTY, MINNESOTA.

THE COMMON COUNCIL OF THE CITY OF ROCHESTER DO ORDAIN:

Section 1. A petition has been filed with the Common Council of the City of Rochester, signed by a majority of the owners of land described herein, requesting the Common Council to annex said land to the City of Rochester. The land described in said petition for annexation is located in Rochester Township, Olmsted County, Minnesota, and is described as follows:

A part of the East One-Half (E 1/2) of the Southeast Quarter (SE 1/4) of the Northwest Quarter (NW 1/4) of Section 3, Township 106 North, Range 14 West, described by metes and bounds, as follows:

Beginning at a point on the West line of said East One-Half (E 1/2) of the Southeast Quarter (SE 1/4) of the Northwest Quarter (NW 1/4), 446.05 feet South of the Northwest Corner of said East One-Half (E 1/2), Southeast Quarter (SE 1/4), Northwest Quarter (NW 1/4) thence East at right angles to the previous course a distance of 126.74 feet, thence South at right angles to the previous course a distance of 88.1 feet, thence West at right-right angles to the previous course a distance of 9.65 feet, thence southwesterly at a deflection angle of 64 degrees 30 minutes to the left from the previous course a distance of 28.05 feet, thence southwesterly at a deflection angle of 21 degrees to the right from the previous course a distance of 38.0 feet, thence Northwesterly at a deflection angle of 79 degrees 30 minutes to the right from the previous course a distance of 58.7 feet, thence west at a deflection angle of 36 degrees to the left from the previous course a distance of 30.0 feet to the west line of said East One-Half (E 1/2) of the Southeast Quarter (SE 1/4) of the Northwest Quarter (NW 1/4), thence North along said West line a distance of 105.0 feet to the place of beginning.

Said petition has also been filed with the Town Board of Rochester Township, with the County Board of the County of Olmsted, and with the Minnesota Municipal Board, and the Town Board of Rochester Township has notified the City that it has no objections to the annexation of the above-described land.

Section 2. The quantity of land included in said petition is approximately 1/3 acre.

Section 3. The Common Council of the City of Rochester does hereby determine that the land described in Section 1 abuts upon the present territorial limit of the City of Rochester, is so conditioned as to be properly subjected to municipal government, and the annexation of said land will be in the best interest of the City of Rochester and the land described.

Section 4. Therefore, the land described in Section 1 above is hereby annexed, added to and made a part of the City of Rochester, Minnesota, as effectually as if it had originally been a part thereof.

Section 5. Present and future owners of the area annexed by this ordinance are hereby notified that in addition to the usual assessments, it is the intention of the Common Council to assess against benefited property all or a portion of the cost of any storm sewer, water tower, and trunk line sanitary sewer construction, heretofore or hereafter undertaken to serve the area annexed.

Section 6. This ordinance shall take effect and be in force from and after its official publication and from and after the filing of a certified copy hereof with the Minnesota Municipal Board, the Rochester Town Clerk, and County Auditor, and the Secretary of State.

Passed and adopted by the Common Council of the City of Rochester, Minnesota, this 20 day of August, 1979.

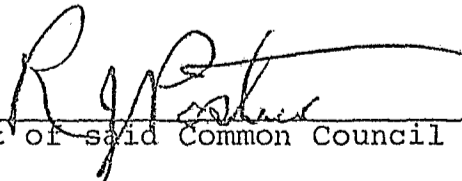

President of said Common Council

Attest: 

City Clerk

Approved this 31 day of August, 1979.

Chuck Hyman
Mayor of said City

(Seal of the City of
Rochester, Minnesota)

STATE OF MINNESOTA
DEPARTMENT OF STATE
FILED
OCT - 1 1979

John Anderson Snow
Secretary of State

432412

STATE OF MINNESOTA)
)
COUNTY OF OLMSTED)

I, DOLORES K. LANIER, DEPUTY CITY CLERK OF THE CITY OF ROCHESTER,
MINNESOTA, DO HEREBY CERTIFY THAT I HAVE COMPARED THE ATTACHED
COPY OF AN ORDINANCE WITH THE ORIGINAL ORDINANCE ON FILE IN MY
OFFICE AND THAT THE FOREGOING IS A TRUE AND CORRECT COPY OF THE
SAID ORDINANCE AND OF THE WHOLE THEREOF.

WITNESS MY HAND THIS 25th DAY OF September, 1979.

Dolores K. Lanier
Deputy City Clerk
City of Rochester, Minnesota

(Seal of the City of
Rochester, Minnesota)

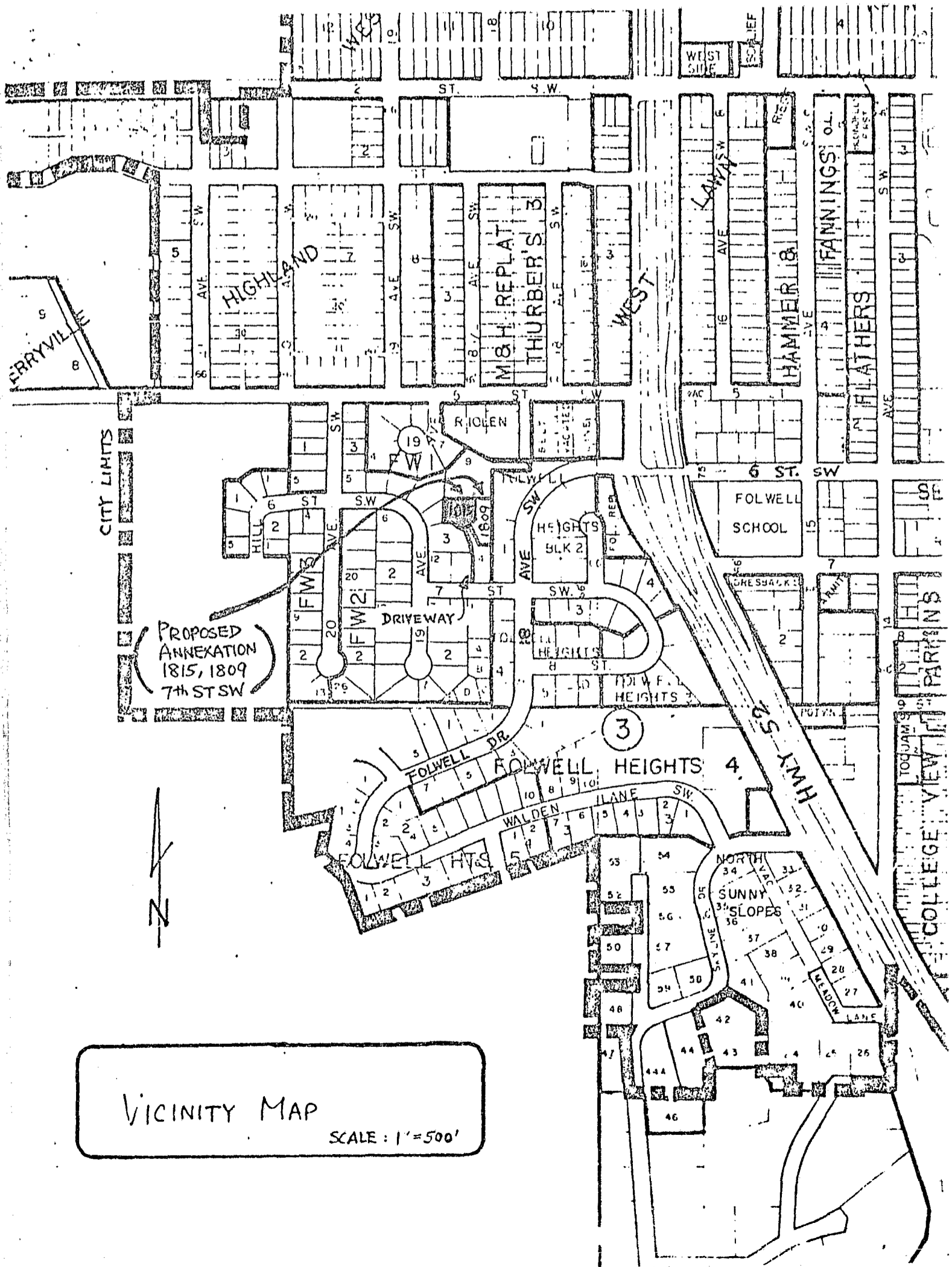

VICINITY MAP
SCALE: 1" = 500'