



STATE OF MINNESOTA  
MUNICIPAL COMMISSION  
304 Capitol Square Building  
10th & Cedar Streets  
St. Paul, Minnesota 55101

August 11, 1972

Mr. Thomas E. Mealey, Admin. Asst.  
City Hall 37 Washington Ave. W.  
Hutchinson, Minnesota 55350

Re: Docket Number A-2194 Ordinance Number 417

Dear Sir:

The Minnesota Municipal Commission acknowledges receipt and filing of the above Ordinance and filing fee in accordance with Minn. Session Laws 1969, Chapter 1146, Section 12 and the Rules of Procedure.

According to law, this annexation is final upon filing a copy of the ordinance with the Town Clerk, County Auditor and Secretary of State in addition to the Municipal Commission.

Please refer to the above docket and ordinance numbers in any future reference to this annexation.

Very truly yours,  
MUNICIPAL COMMISSION  
*[Signature]*  
Howard L. Kaibel, Jr.  
Executive Secretary

BR/mg  
c.c. Secretary of State  
County Auditor  
Township  
Attorney  
Municipality

24288

July 27, 1972

State of Minnesota )  
County of McLeod )  
City of Hutchinson )

I, the undersigned, being the duly qualified and acting City Clerk of the City of Hutchinson, Minnesota, do hereby certify that I have carefully compared the attached copy of

Ordinance No. 417

with the original on file in the Office of the City Clerk, and the same is a full true and complete copy thereof.

WITNESS my hand officially as such City Clerk and the Corporate Seal of the City this 27th day of July, 1972.

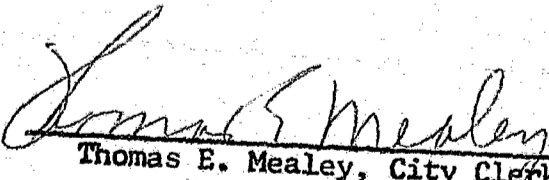
  
Thomas E. Mealey, City Clerk

S E A L

STATE OF MINNESOTA  
DEPARTMENT OF STATE  
FILED

AUG 18 1972

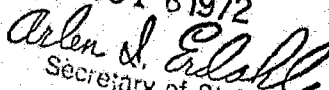
  
Secretary of State

PUBLICATION NO. 1488. PUBLISHED IN THE HUTCHINSON LEADER, FRIDAY,  
JULY 28, 1972

ORDINANCE NO. 417

AN ORDINANCE EXTENDING THE CORPORATE LIMITS OF THE CITY OF  
HUTCHINSON AND ANNEXING THERETO CERTAIN LAND FORMERLY  
LOCATED IN THE TOWNSHIP OF ACOMA

THE CITY OF HUTCHINSON DOES ORDAIN:

SECTION I. A petition has been filed with the governing body of  
the City of Hutchinson by William Helland and the City of Hutchinson,  
being 100% owners of the following described real property, to have  
said property annexed and included within the corporate limits of the  
City of Hutchinson, County of McLeod, State of Minnesota, to wit:

CITY OF HUTCHINSON:

A tract of land in the Northwest Quarter of Section 36, Township 117 North, Range 30 West  
McLeod County, Minnesota described as follows:

Commencing at the Northeast corner of said Northwest  $\frac{1}{4}$  of Section 36; thence North  
89°-55'-00" West along the North line of said Northwest  $\frac{1}{4}$ , a distance of 565.92  
feet to the centerline of County Highway No. 12; thence South 8°-37'-00" East  
along said centerline, a distance of 338.96 feet; thence along a tangent center-  
line curve, radius 2181.89 feet, central angle 19° 23', an arc distance of 738.14  
feet to the point of beginning; thence on a bearing of South 62°-00'-00" West, a  
distance of 208.7 feet; thence on a bearing of North 28°-00'-00" West, a distance  
of 208.7 feet; thence on a bearing of North 62°-00'-00" East to a point on said  
centerline of County Highway No. 12; thence Southerly along said tangent centerline  
curve to the point of beginning. Containing 1.0 Acre more or less, owned by  
City of Hutchinson.

WILLIAM HELLAND:

A tract of land in the Northwest Quarter of Section 36, Township 117 North, Range 30 West  
McLeod County, Minnesota, described as follows:

Commencing at the Northeast corner of said Northwest  $\frac{1}{4}$  of Section 36; thence North  
89°-55'-00" West along the North line of said Northwest  $\frac{1}{4}$ , a distance of 565.92 feet  
to the centerline of County Highway No. 12; thence South 8°-37'-00" East along said  
centerline, a distance of 338.96 feet; thence along a tangent centerline curve, radius  
2181.89 feet, central angle 19°-23', an arc distance of 738.14 feet to the point of  
beginning; thence on a bearing of South 62°-00'-00" West, a distance of 593.12 feet  
to a point in the South line of the North Half of said Northwest  $\frac{1}{4}$  of Section 36; thence  
South 90°-00'-00" East along said South line to a point on the centerline of said  
County Highway No. 12; thence North 28°-00'-00" West along said centerline, a distance  
of 315.37 feet to the point of beginning. Containing 2.15 acres more or less.  
Owned by, William Helland.

SECTION II. The quantity of land embraced within the foregoing  
description and bounded as described, is 3.15 acres, more or less.

SECTION III. The City Council hereby determines that the annexation  
will be to the best interests of the City of Hutchinson and the  
territory affected, and that the territory described herein abuts upon  
the City and is so conditioned as properly to be subjected to City  
Government.

STATE OF MINNESOTA  
DEPARTMENT OF STATE  
FILED

AUG 1 8 1972

*Allen J. Edall*  
Secretary of State

ORDINANCE NO. 417

-2-

SECTION IV. Therefore, the City of Hutchinson, Minnesota hereby declares and ordains that the property hereinbefore described be and the same is annexed to and included in the City of Hutchinson as effectively as if it had originally been a part thereof.

SECTION V. This ordinance shall be final and shall take effect and be in force from and after its passage and publication and after filing a certified copy thereof with the Minnesota Municipal Commission, McLeod County Auditor and the Secretary of State for the State of Minnesota.

Adopted by the City Council this 25th day of July, 1972

Don O. Kost, Mayor

Thomas E. Mealey, City Clerk

24288

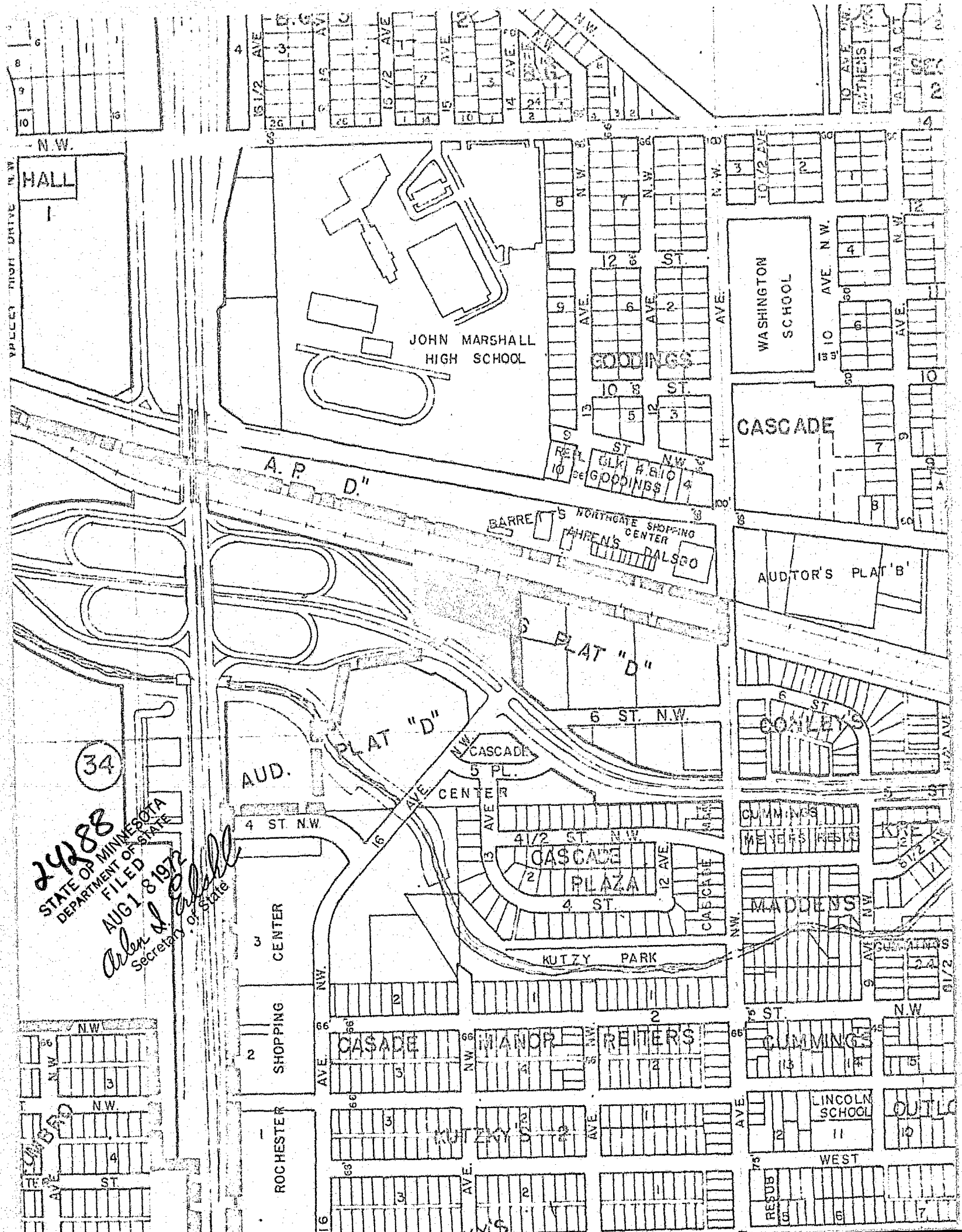

34  
 24288  
 STATE OF MINNESOTA  
 DEPARTMENT OF STATE  
 FILED  
 AUG 18 1972  
*Arden A. [Signature]*  
 Secretary of State