



STATE OF MINNESOTA
MUNICIPAL COMMISSION

30 1/2 Capitol Square Building
10th & Cedar Streets
St. Paul, Minnesota 55101
Oct. 6, 1971

Mrs. Elfreda Reiter, Clerk
City Hall
Rochester, Minnesota

Re: Docket Number A-2063 Ordinance Number 1588

Dear Sir:

The Minnesota Municipal Commission acknowledges receipt and filing of the above Ordinance and filing fee in accordance with Minn. Session Laws 1969, Chapter 1146, Section 12 and the Rules of Procedure.

According to law, this annexation is final upon filing a copy of the ordinance with the Town Clerk, County Auditor and Secretary of State in addition to the Municipal Commission.

Please refer to the above docket and ordinance numbers in any future reference to this annexation.

Very truly yours,

MUNICIPAL COMMISSION

A handwritten signature in cursive script, appearing to read "Bruce Rasmussen".

Bruce Rasmussen
Executive Secretary

BR/mg

c.c. Secretary of State
County Auditor
Township
Attorney
Municipality

23117

1588

ORDINANCE NO. 1588
AN ORDINANCE Annexing to The City of Rochester Minnesota, Certain Platted Land in Auditors Plat "D" and Certain Unplatted Land, All Being in The North Half, Section 34, Township 107 North, Range 14 West, Olmsted County, Minnesota; and Establishing The Zoning Therefor.

THE COMMON COUNCIL OF THE CITY OF ROCHESTER DO ORDAIN:
Section 1. The Common Council of the City of Rochester by resolution adopted on February 1, 1971, declared its intent to annex the following described land in Cascade Township, Olmsted County, Minnesota, which is 60 per cent or more bordered by the City of Rochester:

PARCEL A

Lots 2, 3, 4, and 5 as platted in Auditors Plat "D" and all of the abutting right-of-way of 7th Street N.W.

PARCEL B

All that part of the right-of-way of T.H. No. 52 in the Northeast Quarter, Section 34, Township 107 North, Range 14 West, lying north of the Chicago Northwestern Railroad right-of-way.

PARCEL C

Commencing at Northeast corner of Northwest Quarter of Section 34, Township 107 North, Range 14 West, for a place of beginning; thence south 33 feet; thence west 237.85 feet; thence south, along the east line of lot 1 & 2 Halls 1st Add., a distance of 350 feet to the Southeast corner of said lot 2; thence west along the south line of said lot 2, a distance of 262.50 feet to the east right-of-way line of Valleyhigh Drive N.W.; thence south along said east right-of-way line to a point 110 feet north of the intersection of the north line of the N.W. & east line of Valleyhigh Drive N.W.; thence east perpendicular to the east line of Valleyhigh Drive N.W., a distance of 110 feet; thence south parallel with the east line of Valleyhigh Drive N.W., to the center line of 7th Street N.W.; thence southerly along said centerline a distance of 69.34 feet. Thence southerly at right angles to said center line, a distance of 130.60 feet to the north right-of-way line of Chicago Northwestern Railroad; thence southerly along said R.R. Right-of-way line, a distance of 392.70 feet to the east line of the Northwest Quarter, Section 34, Township 107 North, Range 14 West; thence northerly along said east line, a distance of 1311.48 feet, more or less, to the point of beginning.

The said resolution was thereafter duly served upon the Town Board of Cascade Township, and after said service, sixty days has elapsed without objection being filed by the Town of Cascade with the Minnesota Municipal Commission.

Section 2. The land described in Section 1 above comprising of approximately 24.0 acres is hereby annexed, added to and made a part of the City of Rochester, Minnesota, as effectually as if it had been originally a part thereof.

Section 3. Present and future owners of the area annexed by this ordinance are hereby notified that in addition to the usual assessments, it is the intention of the Common Council to assess against benefited property all or a portion of the cost of any storm sewer, water tower and trunk line sanitary construction heretofore or hereafter, undertaken to serve the area annexed.

Section 4. Pursuant to Section 14.06 of Ordinance No. 1296, as amended, known as the Zoning Ordinance of the City of Rochester, Minnesota, the lands herein annexed to the City of Rochester shall be designated on the Zoning Map of said Ordinance No. 1296 in the districts indicated as follows:

State of Minnesota,
County of Olmsted,
City of Rochester, SS

I, Elfreda Reiter, City Clerk of the City of Rochester,

Minnesota, do hereby certify that I have compared the attached copy of an ordinance with the original ordinance on file in my office and that the foregoing is a true and correct copy of the said ordinance and of the whole thereof.
Witness my hand this 1st day of September, 1971.

(Seal of the City of Rochester, Minnesota)

Elfreda Reiter
City Clerk of City of Rochester,
Minnesota

R-3 Multi-Family Residence District
All that part of the right-of-way of T.H. No. 52 in the Northeast Quarter, Section 34, Township 107 North, Range 14 West, lying north of the Chicago Northwestern Railroad right-of-way and east of the centerline of said T.H. NO. 52.
M-1 Light Manufacturing District
Lots 2, 3, 4, and 5 as platted in Auditor's Plat "D" and all the abutting right-of-way to the center line of 7th Street N.W.
M-1 Light Manufacturing District
All that part of the right-of-way of T.H. No. 52 in the Northeast Quarter, Section 34, Township 107 North, Range 14 West, lying north of the Northwestern Railroad right-of-way and south of the center line of 7th Street N.W.
M-2 General Manufacturing District
Commencing at Northeast corner of Northwest Quarter of Section 34, Township 107 North, Range 14 West, for a place of beginning; thence south 33 feet; thence west 237.85 feet; thence south, along the east line of lot 1 & 2 Halls 1st Add., a distance of 350 feet to the Southeast corner of said lot 2; thence west along the south line of said lot 2, a distance of 262.50 feet to the east right-of-way line of Valleyhigh Drive N.W.; thence south along said east right-of-way line to a point 110 feet north of the intersection of the north line of the N.W. & east line of Valleyhigh Drive N.W.; thence east perpendicular to the east line of Valleyhigh Drive N.W., a distance of 110 feet; thence south parallel with the east line of Valleyhigh Drive N.W., to the center line of 7th Street N.W.; thence southerly along said centerline a distance of 69.34 feet. Thence southerly at right angles to said center line, a distance of 130.60 feet to the north right-of-way line of Chicago Northwestern Railroad; thence southerly along said R.R. right-of-way line, a distance of 392.70 feet to the east line of the Northwest Quarter, Section 34, Township 107 North, Range 14 West; thence northerly along said east line, a distance of 1311.48 feet, more or less, to the point of beginning; and including all that part of the abutting right-of-way of T.H. No. 52 in the Northeast Quarter, Section 34, Township 107 North, Range 14 West, lying North of the Chicago Northwestern Railroad right-of-way and west of the center line of T.H. No. 52.
Section 5. This ordinance shall take effect and be in force from and after its official publication and from and after the filing of a certified copy hereof with the Minnesota Municipal Commission, the County Auditor, the Secretary of State, and the Secretary of the Common Council of the City of Rochester, Minnesota, on this 3rd day of May, 1971.
R. J. POSTIER
President of said Common Council
Attest: ELFREDA REITER
City Clerk
Approved this 4th day of May, 1971.
DEWEY DAY
Mayor of said City
(Seal of the City of Rochester, Minnesota)
15/8 5/15!

23117
STATE OF MINNESOTA
DEPARTMENT OF STATE
FILED

NOV - 8 1971
Arden A. Edsall
Secretary of State

(23)

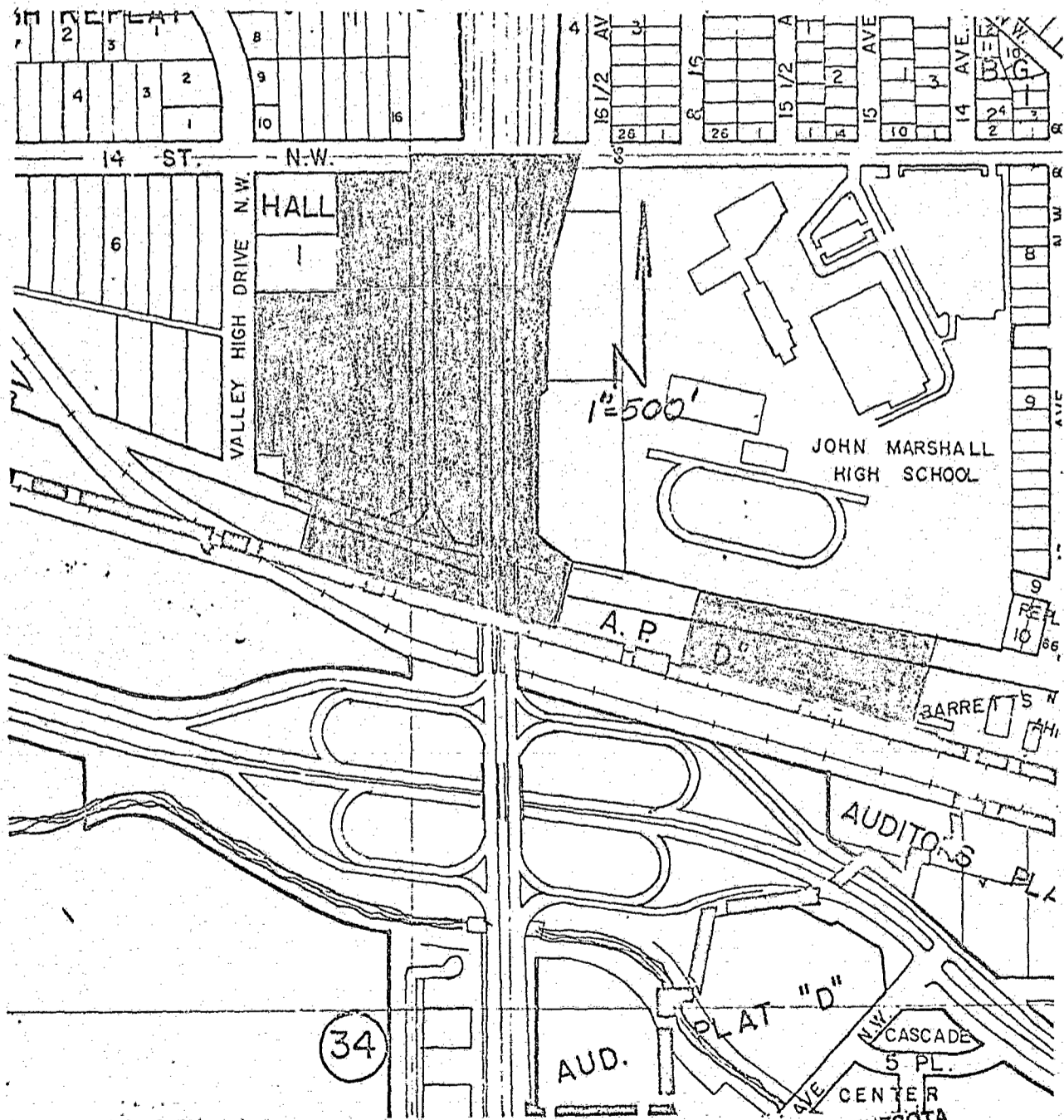

STATE OF MINNESOTA
DEPARTMENT OF STATE
FILED

NOV - 8 1971

Arden W. Edsall
Secretary of State

23117

old
#1588