

Phone: 221-2428



STATE OF MINNESOTA
MUNICIPAL COMMISSION

610 Capitol Square Building
10th & Cedar Streets
St. Paul, Minnesota 55101

Jan. 11, 1971

Mr. W. E. Fahey, Clk.-Treas.
City Hall
Thief River Falls, Minnesota

Re: Docket Number A-1858 Ordinance Number 363

Dear Sir:

The Minnesota Municipal Commission acknowledges receipt and filing of the above Ordinance and filing fee in accordance with Minn. Session Laws 1969, Chapter 1146, Section 12 and the Rules of Procedure.

According to law, this annexation is final upon filing a copy of the ordinance with the Town Clerk, County Auditor and Secretary of State in addition to the Municipal Commission.

Please refer to the above docket and ordinance numbers in any future reference to this annexation.

Very truly yours,

MUNICIPAL COMMISSION

Bruce Rasmussen

Bruce Rasmussen
Executive Secretary

BR/mg

c.c. Secretary of State
County Auditor
Township
Attorney
Municipality

72033

RESOLUTION

9-101-70

At a regular meeting of the City Council held Sept. 22, 1970

Alderman Wigness seconded by Alderman Froiland introduced the

following resolution and moved its adoption:

ORDINANCE NO. 363
AN ORDINANCE ANNEXING CERTAIN LANDS TO THE CITY OF THIEF RIVER FALLS

The City Council of the City of Thief River Falls do hereby ordain as follows:

Section 1.

WHEREAS all of the owners of the following described premises situated in the County of Pennington and State of Minnesota, to-wit:

The Northwest Quarter of the Southwest Quarter (NW 1/4 SW 1/4) of Section Three (3) in Township One Hundred Fifty-Three (153) North of Range Forty-three (43) West; less that portion of said quarter occupied by Mpls.-St. Paul & Sault St. Marie Railroad right-of-way containing forty (40) acres more or less,

have petitioned the City Council to have such land included within the municipality and have filed copies of said petition with the Municipal Commission of the State of Minnesota, with the Town Board of the Township of Rocksbury and with the County Board of the County of Pennington, State of Minnesota, and

WHEREAS the above described property abuts upon the boundaries of the City of Thief River Falls, and

WHEREAS no objections to the proposed annexation have been submitted,

NOW, THEREFORE, IT IS HEREBY determined that the annexation of said premises will be to the best interest of the City of Thief River Falls and of the territory affected and the above described premises are hereby declared annexed to the City of Thief River Falls.

Section 2.

This ordinance shall be in force and effect from and after its passage, approval, publication and filing with the Municipal Commission, Town Clerk, the Pennington County Auditor and the Secretary of State of the State of Minnesota

22033
STATE OF MINNESOTA
DEPARTMENT OF STATE
FILED
JAN 14 1971
Arden J. Edsall
Secretary of State

ROLL CALL

Aldermen voting Aye: Carlson, Engelstad, Wysoski, Froiland, Wigness, Narverud and Rambeck.

Aldermen voting Naye: None.

Presented to the Mayor Sept. 23, 1970

Approved September 23, 1970

Dr. A. E. Jacobsen Mayor

Returned by the Mayor Sept. 23, 1970

Resolution declared passed
Robert J. Carlson
President of the Council

Attest: William E. Fahey
City Clerk

CERTIFICATE

STATE OF MINNESOTA)
COUNTY OF PENNINGTON) ss.

In the Matter of the Petition
of Certain Freeholders For
Annexation of Unincorporated
and Unplatted Property To the
City of Thief River Falls.

Pursuant to Rule 116(b) of the Minnesota Municipal
Commission Rules of Practice, I hereby certify that the
Petition of E.J. Bruggeman, et al was filed with the County
Board of the County of Pennington, Minnesota, on the 21st
day of May, 1970, and with the Town Board of the Town of
Rockstar, County of Pennington, Minnesota, on the 19th day
of June, 1970.

/s/ Lawrence A. McDowell
Lawrence A. McDowell
Assistant City Attorney

June 19, 1970.

22033
STATE OF MINNESOTA
DEPARTMENT OF STATE
FILED
JAN 14 1971
Allen J. Edsall
Secretary of State

STATE OF MINNESOTA)
)ss.
COUNTY OF PENNINGTON)

In the Matter of the Petition)
of Certain Freeholders for An-)
nexation of Unincorporated and)
Unplatted Property to the City)
of Thief River Falls.)

TO THE CITY COUNCIL OF THE CITY OF THIEF RIVER FALLS:

Pursuant to the provisions of M.S.A. 414.033 Subd. 5
your petitioners respectfully represent:

That they are all of the owners of the following
described parcel of property situated in the County of Pennington
and State of Minnesota, to-wit:

The NW $\frac{1}{4}$ of the SW $\frac{1}{4}$ of Section 3, T.153N, R.43W;
less that portion of said quarter occupied by
Mpls. - St. Paul & Sault St. Marie Railroad
right-of-way containing 40 acres more or less.

That said parcel abuts upon the City of Thief River Falls
and is not included in any other municipality. That the quantity
of land embraced herein and proposed to be annexed is about 40
acres more or less.

That the undersigned owners of said property hereby peti-
tion the City Council of the City of Thief River Falls to annex
said property into the city limits of said city.

Dated April 16, 1970.

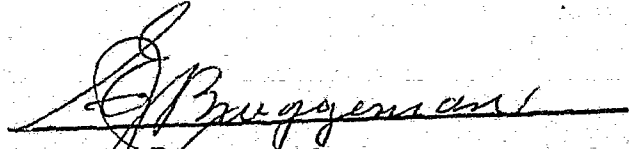
E. J. Bruggeman

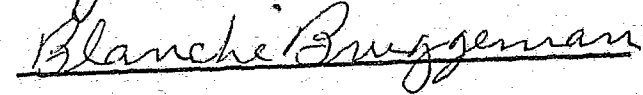
Blanch Bruggeman

Kenneth G. Noreen

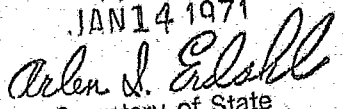
22033
STATE OF MINNESOTA
DEPARTMENT OF STATE
FILED
JAN 14 1971

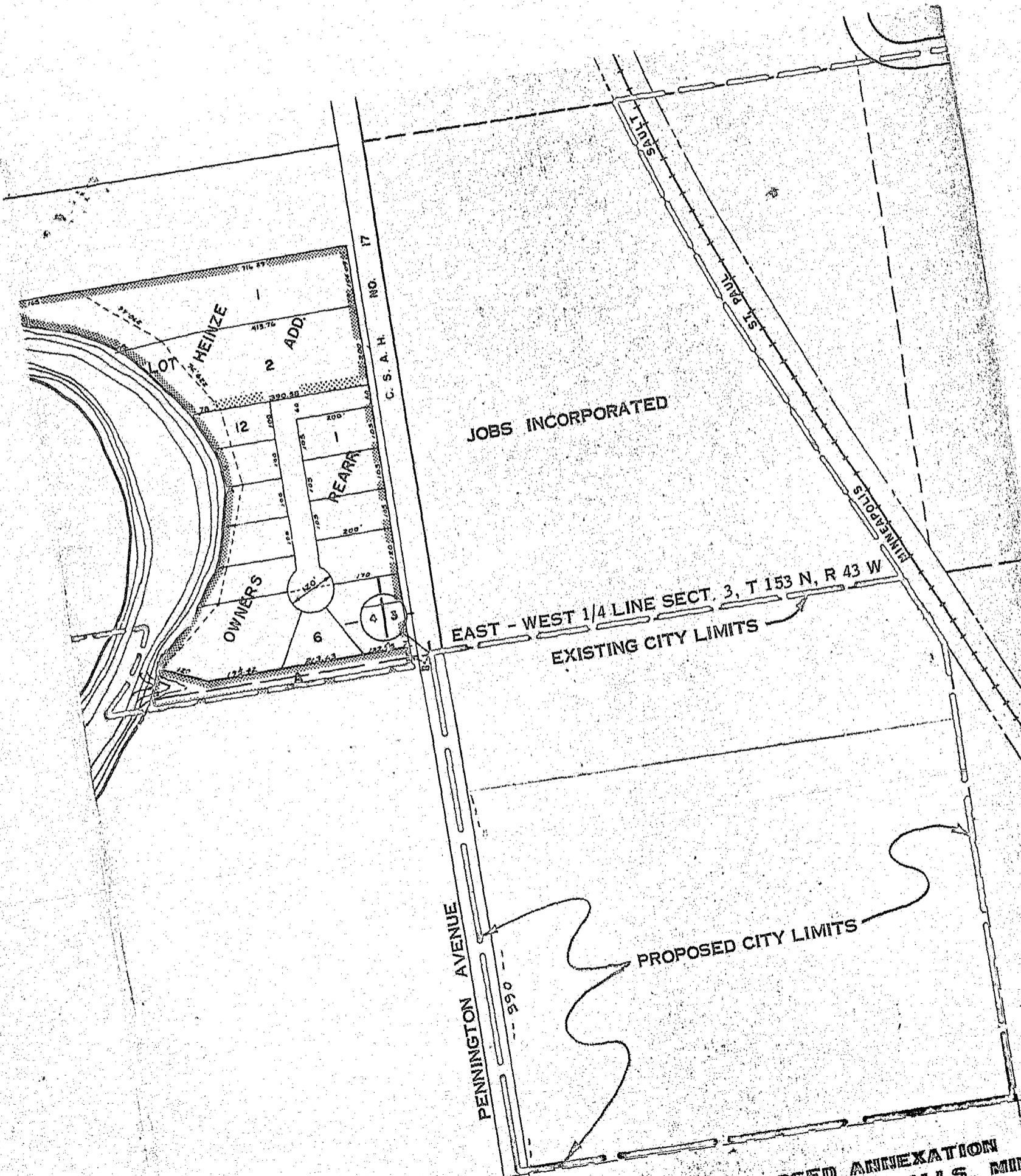
Secretary of State



JOBS INCORPORATED

EAST - WEST 1/4 LINE SECT. 3, T 153 N, R 43 W
EXISTING CITY LIMITS

PROPOSED CITY LIMITS

SKETCH OF PROPOSED ANNEXATION
TO CITY OF THIEF RIVER FALLS, MINN.
OF NOREEN - BRUGGEMAN PROPERTY
APRIL 3, 1970